

# P-250iA/15™

## Basic Description

FANUC Robotics' P-250iA/15 is a full-size painting robot with industry's best work envelope and motion performance. The P-250iA/15 is designed for efficient process equipment integration with features such as a hollow wrist and option for two motors on the outer arm for gear pumps, an outer arm designed for easy integration of paint application equipment, and multiple hose routing options. This provides increased throughput and spraying time which improves transfer efficiency.

## Features and Benefits

- Floor and invert mounting permits versatility when unusual workpiece access is required.
- Patented, production proven, hollow wrist and through-arm hose routing provide a clean application environment.
- Options for either in-arm gear pump or mounting space for an in-arm flow meter and color valves provide fluid delivery flexibility with minimized color change time and material waste.
- FM and CE Mark Hazardous approval in process for Class I and II, Div. 1, Groups C,D,E,F,G environments.
- TIIS approval in process.
- Flex field hose makes for fast installation.
- Alternate Roxtec RS seal for CE Mark installation.



- Ability to “flip-over” axis 2 and 3 to provide a very large work envelope and maximum flexibility for painting.
- Payload sized to carry a variety of applicators including conventional and electrostatic air spray guns and rotary atomizers.
- Optional ROBOGUIDE® PaintPRO™ software is a user-friendly Windows®-based graphical programming interface for creating, viewing, editing and simulating robot programs.

## Reliability and Maintenance Advantages

- Designed for painting environment
- 12th generation paint robot designed with production proven reliability

- Internally and externally sealed wrist
- Large wrist aperture

## Software

- Line tracking
- Automatic color change
- Analog parameter control
- Integral two-component variable ratio or one-component pump control
- ACCUFLOW™ closed loop fluid control for paint applications
- Accuchop™ closed loop fluid control for FRP applications
- Collision Guard

**FANUC**  
Robotics

# P-250iA/15 Dimensions

## Isometric

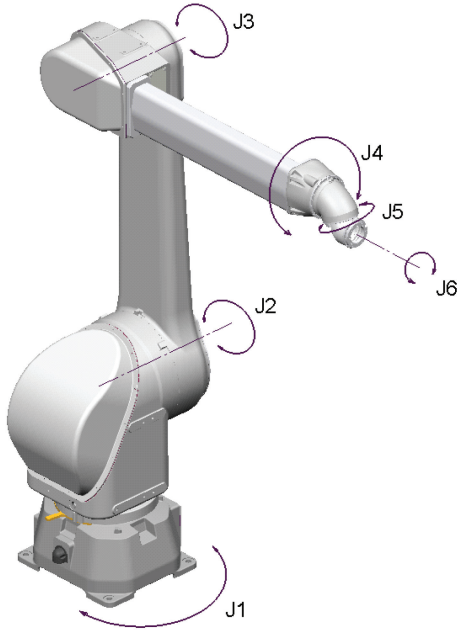

## Top

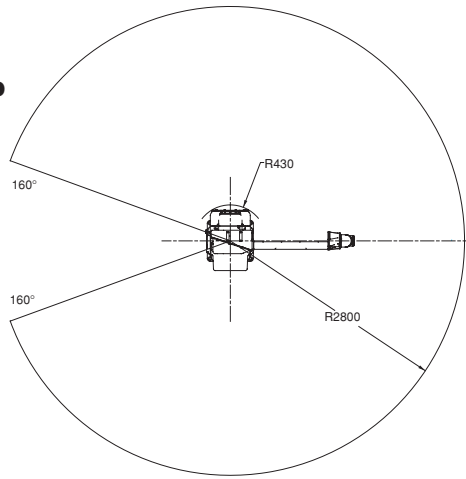

## Footprint

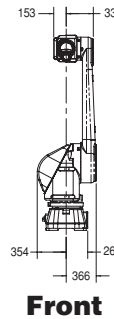
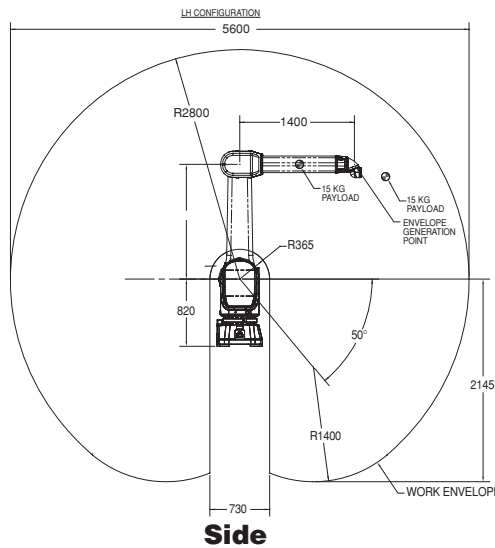
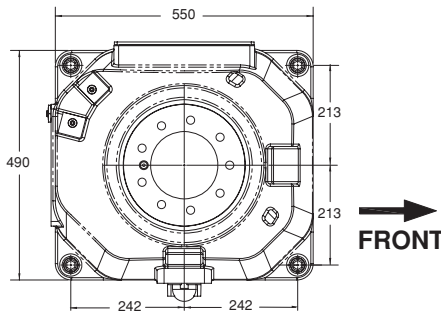

## Front

# P-250iA/15 Specifications

Items		
Motion range (degrees)	J1	320
	J2	280
	J3	330
	J4	1080
	J5	1080
	J6	1080
Motion speed <sup>(1)</sup> (degrees/s)	J1	160
	J2	160
	J3	160
	J4	375
	J5	430
	J6	545
Coating speed (mm/s)		1500
Wrist payload <sup>(2)</sup> (kg)		15
Outer arm payload (kg)		15
Repeatability (mm)		±0.2
Mechanical brakes	Axes 2, 3 (optional 1,4,5,6)	
Certification (in process)	FM, CE Mark, TIIS	
Weight (kg)		520

### Notes:

- (1) Optional high speed wrist (550, 550, 710 degrees/s)
- (2) At 300 mm axial, 50 mm radial offset. Please contact FANUC Robotics for high speed wrist payload.

## Wrist

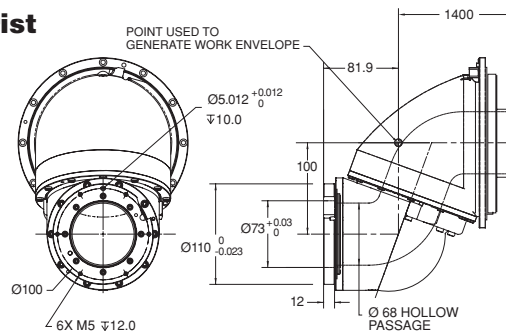

**Note:** Dimensions are shown in millimeters. Detailed CAD data are available upon request.



**FANUC Robotics America, Inc.**  
 3900 W. Hamlin Road  
 Rochester Hills, MI 48309-3253  
 (248) 377-7000  
 Fax (248) 377-7362

Charlotte, NC  
 (704) 596-5121

Toronto, Canada  
 (905) 812-2300

Chicago, IL  
 (847) 898-6000

Montréal, Canada  
 (450) 492-9001

**For sales or technical information, call:**  
 1-800-47-ROBOT

Cincinnati, OH  
 (513) 754-2400

Aguascalientes, Mexico  
 52 (449) 922-8000

Los Angeles, CA  
 (949) 595-2700

Sao Paulo, Brazil  
 (55) (11) 3619-0599

[marketing@fanucrobotics.com](mailto:marketing@fanucrobotics.com)  
[www.fanucrobotics.com](http://www.fanucrobotics.com)

Toledo, OH  
 (419) 866-0788